

Thank you for purchasing this Autel MaxiSys Elite II Pro. Our tools are manufactured to a high standard and — when used according to these instructions and properly maintained — will provide years of trouble-free performance.

MaxiSys Elite II Pro

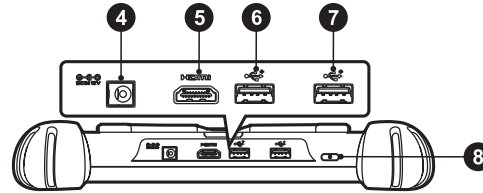
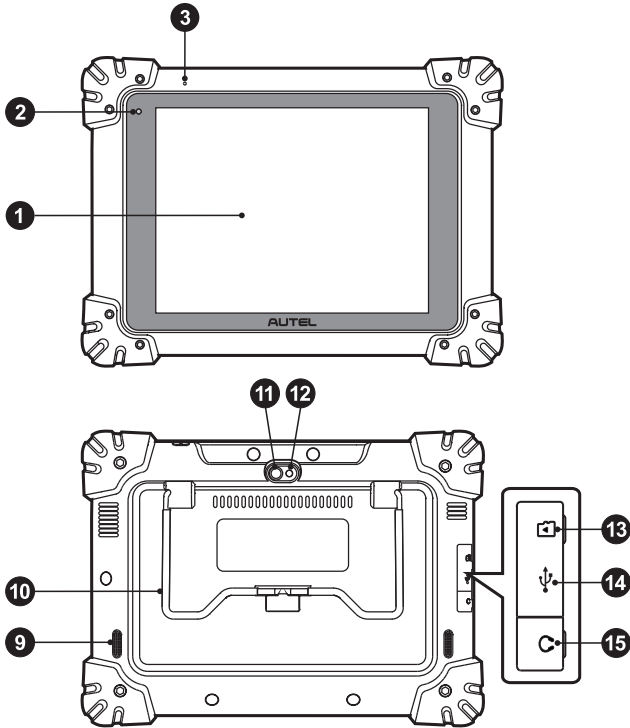

1. 9.7-inch LED Capacitive Touchscreen
2. Ambient Light Sensor — detects ambient brightness
3. Microphone
4. DC Power Supply Input Port
5. HDMI Port
6. USB Port
7. USB Port
8. Power/Lock Button — long press to turn on/off the tablet, or tap to lock the screen
9. Speaker
10. Collapsible Stand — extends from the back to allow hands-free viewing of the tablet
11. Rear Camera
12. Camera Flash
13. Mini SD Card Slot
14. Mini USB Port
15. Headphone Jack

MaxiFlash VCI

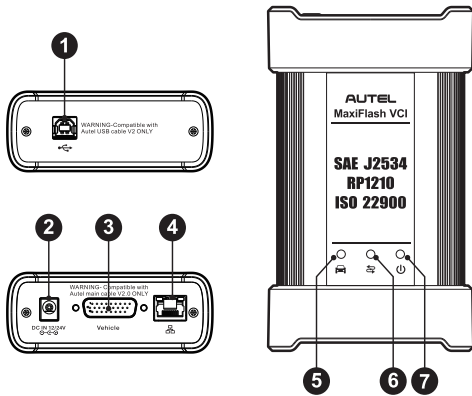

1. USB Port
2. DC Power Supply Input Port
3. Vehicle Data Connector
4. Ethernet Port
5. Vehicle LED — flashes green when communicating with the vehicle
6. Connection LED — refer to Table 1-1 Connection LED Description for details
7. Power LED — refer to Table 1-2 Power LED Description for details

Table 1-1 Connection LED Description

LED	Color	Description
Connection	Green	Lights solid green when connected to the tablet via the USB cable.
	Blue	Lights solid blue when connected via Bluetooth.

Table 1-2 Power LED Description

LED	Color	Description
Power	Yellow	Lights yellow automatically at power-up when VCI is self-testing.
	Green	Lights solid green when powered on.
	Red	<ul style="list-style-type: none"> • Lights solid red when system failure has occurred. • Flashes red when VCI is upgrading.

GETTING STARTED



IMPORTANT: Before operating or maintaining this unit, please read these instructions carefully, paying extra attention to the safety warnings and precautions. Use this unit correctly and with care. Failure to do so may cause damage and/or personal injury and will void the product warranty.



WARNING: The MaxiFlash VCI is compatible with Autel main cable V2.0 and USB cable V2 only.

1

Connect the main cable V2.0 to the Vehicle Data Connector on the VCI unit, and tighten the thumb screws.

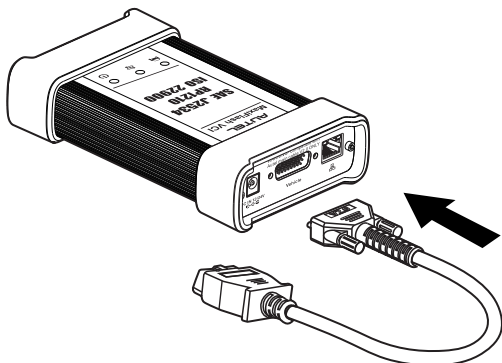

2

Connect the cable's 16-pin adapter to the vehicle's DLC, which is generally located under the vehicle dash.

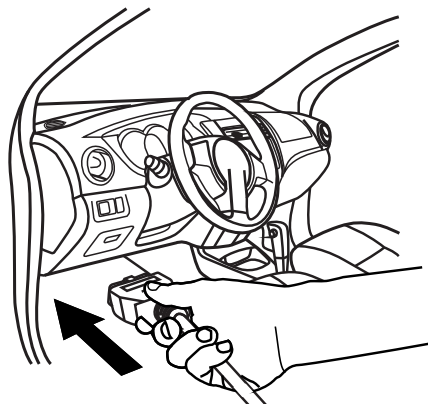

3

Power up the tablet. Ensure the tablet has a charged battery or is connected to the supplied DC power supply.

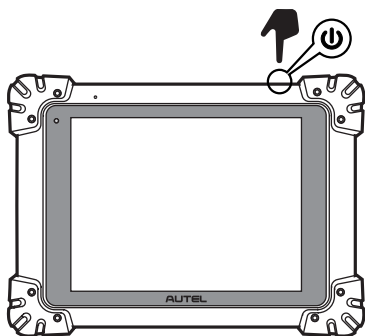

4

Connect the tablet with the VCI via Bluetooth or USB cable. Use only the USB cable connection when programming.

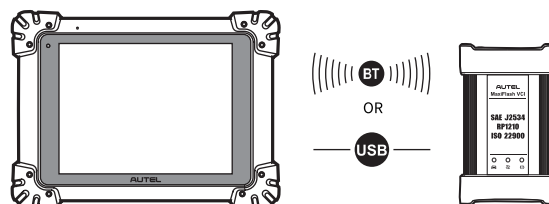

5

When the VCI device is properly connected to the vehicle and the tablet, the VCI status button on the bottom tool bar of the screen shows a green badge, indicating the platform is ready to start vehicle diagnosis.

